

— Product Accessories' and Exploded Diagram

Exploded Picture

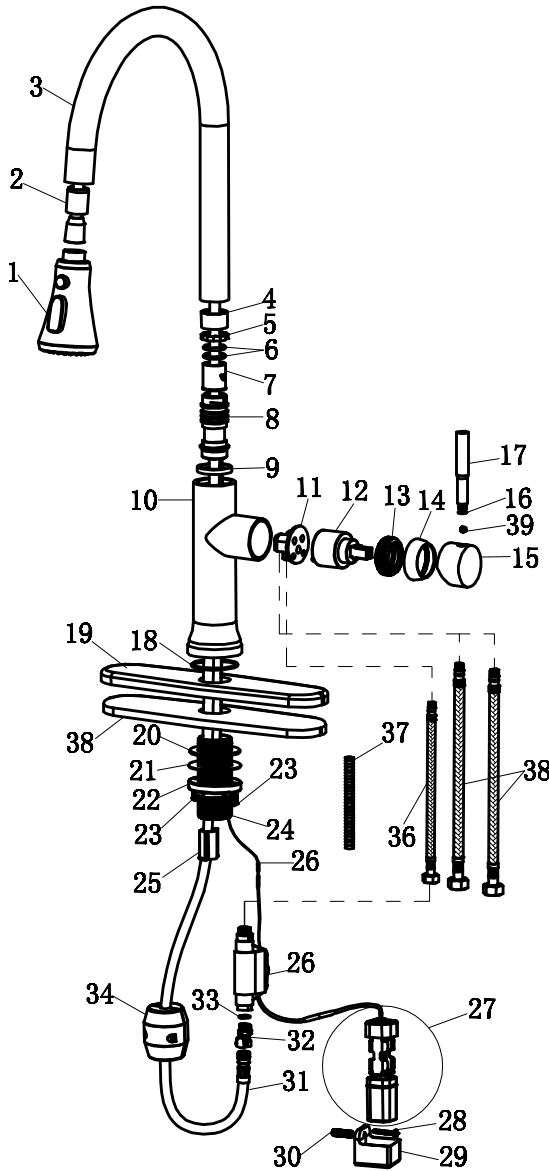

39		screw	M5X5	1
38		washer		1
37		corrugated pipe	PEX-90MM	1
36		inlet braided hose	red and blue 800 length	2
35		outlet braided hose	M15X1	1
34		gravity ball	locknut included	1
33		washer	ø14*2.5	1
32		quick-plug connector	M16X1	1
31		draw-tube	nylon	1
30		expanded rubber		1
29		battery holder	41X43	1
28		self-tapping screw	M4X19	1
27		battery case	41X70	1
26		controller	black	1
25		touch inductive wire	ø3X400	1
24		corrugated tube	M32X1.5	1
23		screw	M6*12	2
22		nut	M32X1.5	1
21		metal sheet/plate	51. 5X32. 5X1	1
20		black rubber gasket/washer	black soft plastic	1
19		base	252X63	1
18		O-ring	ø46Xø2	1
17		handle post	ø12X75	1
16		O-ring	ø9X1.5	1
15		handle	ø41X25.3	1
14		cover ring	M37X1.25	1
13		screw nut	M37X1.25	1
12		cartridge	35 flat QD red	1
11		cartridge cover	ø36.8	1
10		body	ø53X170	1
9		insulating sleeve	ø34X4.6	1
8		elbow connector/hands connector	M24*1.5Xø28X62	1
7		snap springs		1
6		O-ring	ø2.5Xø22.5	2
5		locating rings	ø26X4.4	1
4		steel bushing	ø25.6X15	1
3		elbow	ø28X271X308	1
2		hose sleeve	black	1
1		put-out shower head	ø57X102	1
serial number	code	name	specification	Usage

installation accessories' diagram

locknut	metal sheet	washer	battery case holder	battery case	controller	
screw	screw	expanded rubber	self-tapping screw	gravity ball	base	

二 Installation instructions

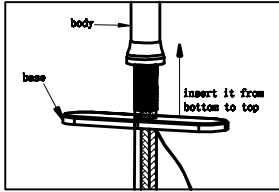

1. Insert the base to the corrugated tube from bottom to top.

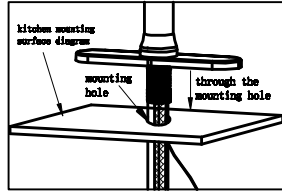

2. Pass the body and base through the mounting holes

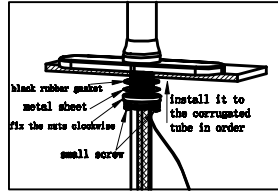

3. Insert the washer-metal sheet-locknut-small screw into the corrugated tube in order and tighten and fix the faucet (clockwise rotation).

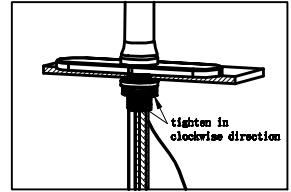

4. Use a Phillips screwdriver to tighten the 2 small screws clockwise

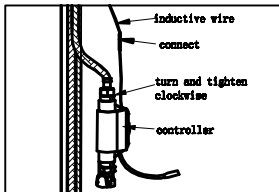

5. Tighten the controller clockwise and connect the touch inductive wire

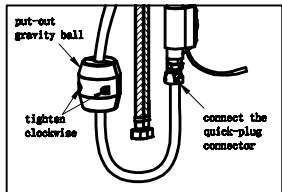

6. Tighten the gravity ball clockwise with a screw at an appropriate position of the put-out tube, and insert the tube connector into the quick-plug connector of the controller.

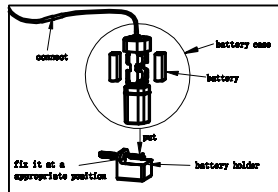

7. Fix the battery holder on the wall with self-tapping screws at the appropriate position, put the battery into the battery case and then place it on the holder. Connect the positive and negative pole of the battery correctly.

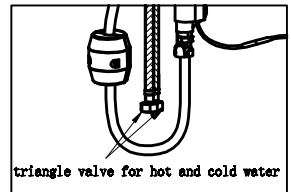

8. red and blue inlet braided hose to connect hot and cold

Installation Instruction:

1. Drain off the water in order to eliminate the impurities for one minute before installation
2. Check if there is any leakage from every joint after installation, and then check if it functions well
3. Pay attention to the installation of positive and negative poles of the battery
4. Do not suspend the battery case, neither put it inside the bathroom cabinet, nor tie the battery wires. The battery case should be grounded, and mounted against the wall.
5. The Stainless steel braided tube should be connected to the valves for both hot and cold water
6. Operating temperature and ambient temperature: 4°C-60°C. Please pay special attention to the hose which is connected with showers should be far away from the heater, otherwise it may cause damage to the shower and its sealing parts, and even will be harmful to the user.

Installation completed diagram

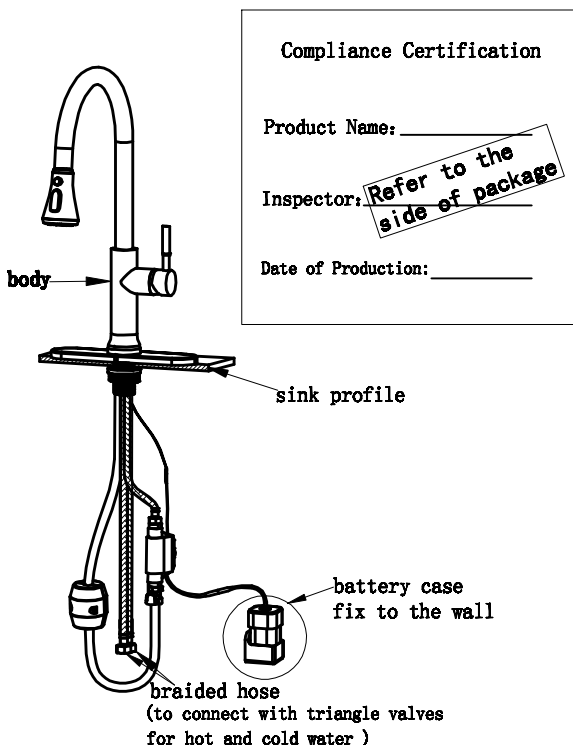

Instructions

Brief description of the operations:

1. Pull out the handle to adjust the flow, and move the handle toward left or right to adjust the hot and cold water temperature.
2. Touch the faucet's large elbow to turn the water on and off, and the elbow can rotate 360°.
3. Water outlet of adjustable bubble-type shower head: blade-type water outlet-shower-type water outlet effect; the shower head can be pulled out and retracted randomly.

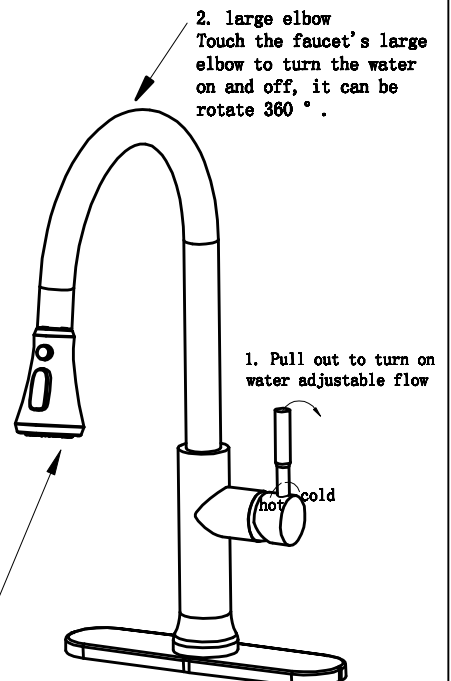

3. shower head Water outlet of adjustable bubble-type—blade-type water outlet—shower-type water outlet effect (available to be pulled out and retracted randomly)