

Slide and Swing Set

User's Manual

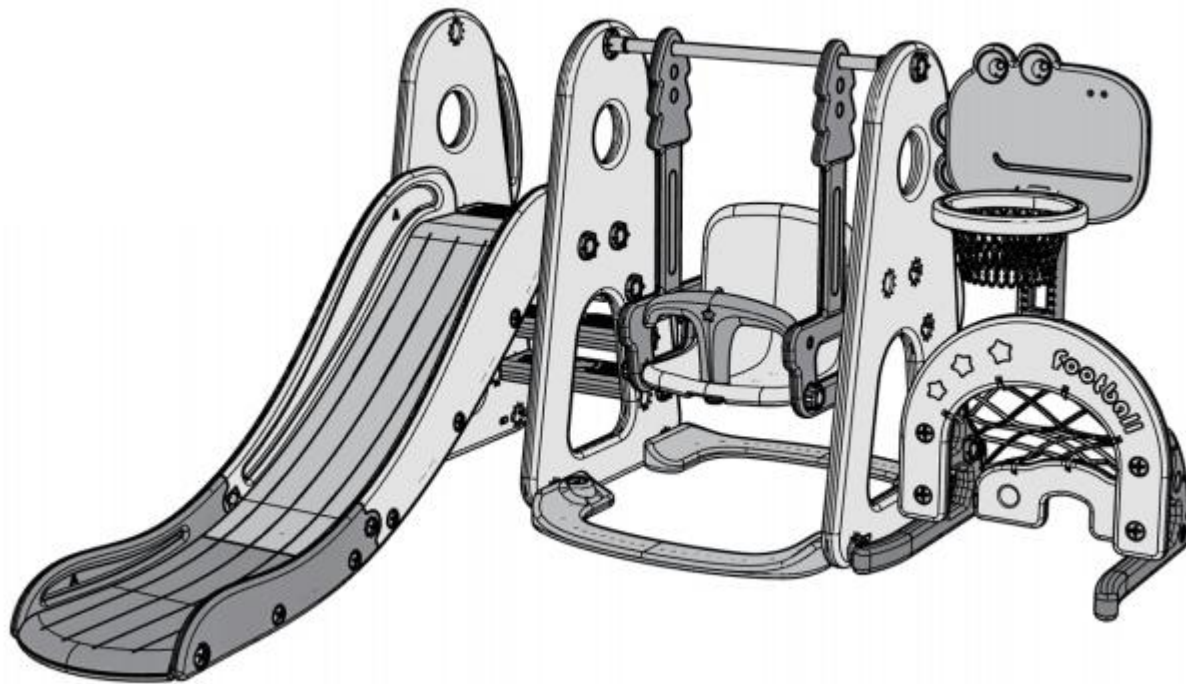

PLEASE DO NOT RETURN PRODUCT TO THE STORE
If you have any problem or concerns, please feel free to contact our
customer service department. We will reply you as soon as possible.

E-Mail: wmcsr@comptree.net
Tel: 626-912-8886 Ext.100

WF212510AAA

WARNINGS



ADULT ASSEMBLY REQUIRED

CHOKING HAZARD - Small Parts

For children 18 months and up.

Please read these warnings and the information in this manual in its entirety.

Failure to comply with the following instructions may increase the risk of serious injury and/or death:

- This unit must be assembled and disassembled by **ADULTS ONLY**.
- This Slide is suitable for use by most children 1 to 8 years of age.
- Never use this product in any manner other than its intended use.
- **DO NOT** exceed the maximum weight limit of 110lbs (50kgs) regardless of age.
- **DO NOT** install this equipment over concrete, asphalt, or any other hard or rough surface. The Slide should always be installed over an appropriate, stable surface (rubber mat, grass, etc).
- Carpeting and thin mats are generally not adequate protective surfacing. Ground level equipment—such as a sandbox, activity wall, playhouse or other equipment that has no elevated play surface—does not need any protective surfacing.
- **ALWAYS** locate this equipment on a stable, level surface **AT LEAST 7 feet** away from any structure, obstruction, or possible hazard(s) such as walls, pools, power lines, verhangs, other playground equipment, driveways, hard surfaces and/or roadways.
- Children must be supervised at all times when using this equipment. **DO NOT** leave children unattended at any time. This Slide is **NOT** for adult or adolescent use.
- **DO NOT** attach items to the Slide not specifically designed for this purpose. Especially in the case of jump ropes, chains, clotheslines, pet leashes and cables. These may cause a strangulation or physical hazard.
- This Slide is only designed for family residential use. **NOT** intended for commercial applications and/or use in public areas such as schools, parks, nurseries, day schools, day cares, etc. **DO NOT** allow more than one child on the Wavy Slide and Ladder at a time.
- Instruct children to always be sure that the chute opening at the bottom is clear of any persons, pets or obstructions before sliding.
- **DO NOT** allow children to wear glasses or helmets when using the slide.
- At the time of disposal, this item must be completely disassembled and separated into its component types (plastics) for recycling or pick-up according to local ordinances for sanitation pickup.
- **DO NOT** allow children to wear loose fitting clothing, clothing with straps/loops, backpacks or wear and/or hold accessories with straps or loops, or any article of clothing or accessory with sharp edges which may present a hazard or become snagged or caught on the Slide during use. Serious injury and/or accidental strangulation may occur.
- **DO NOT** place objects on or under the slide, or allow people and pets to stand or sit on, near or under the Slide and Ladder when in use.
- **DO NOT** allow children to stand on the slide, attempt to walk up the slide – this can cause serious injury. Children must **ALWAYS** remain securely seated, in the forward facing position when sliding. Do not lay down, slide from a standing position, or slide down the chute back-wards. **DO NOT** allow children to stand on the slide top.
- **DO NOT** use in adverse weather conditions, while the seats are wet, or in poorly lit conditions.
- It is recommended that children wear long pants when using this slide to prevent friction of skin against the chute. At the end of the play season or when the temperature drops below 40 degrees F, this unit must be stored indoors, or disassembled and stored inside.
- Please read and refer to other warnings and use information in the Slide instructions before use.
- Before each use of this product and twice per month, inspect and re-place any worn, loose, defective or missing parts and/or bolts. It is important to check the entire Slide to ensure the Chute is in good condition. If any loose, cracked, missing, or other damaged components are found, cease use of this item immediately. If removed for winter storage, reinstall any plastic parts before allowing use.
- Owners shall be responsible for maintaining the legibility of the warning labels.

PARTS LIST

(NOTE: You will get a basketball, a football, two golf balls and a golf club for free)

SLIDE PARTS LIST



A Slide(Upper Part) *1



B Slide(Down Part) *1

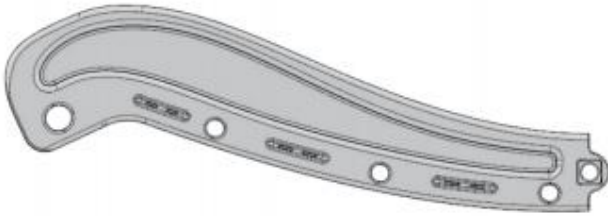

C¹ Upper Side Panel(Right Side)
C² Upper Side Panel(Left Side)



D¹ Down Side Panel(Right Side)
D² Down Side Panel(Left Side)



F Steps *4



E Swing and Slide Side Board*3

SWING PARTS LIST



G Swing Seat*1



H Swing Armrest*1



I Swing Base*2

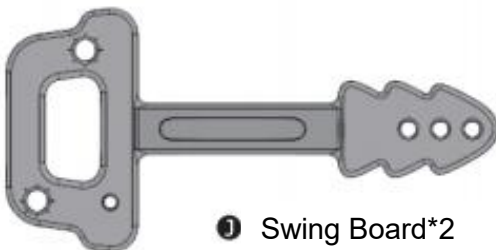

J Swing Board*2



K Stick*1

BASKETBALL STAND PARTS LIST

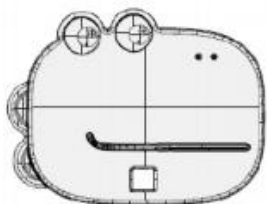

L Dinosaur Board*1

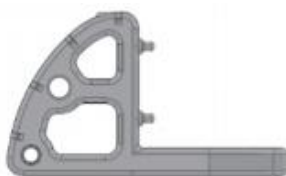

M Side Panel*2



N Back Board*1



O Football Gate*1



P Football Net*1



Q Basketball Hoop*1

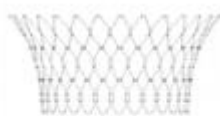

R Basketball Net*1



Hex Wrench



Wrench

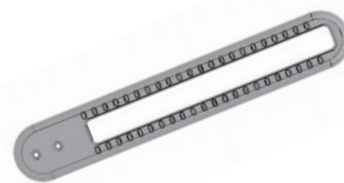

S Pole*1

ACCESSORIES LIST



a + Shaped Nut
*20



b Square Screw
*2



c Flower Nut
*18

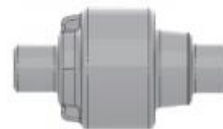

d Connector*1



e Round Screw*5



f Stopper*2
(for basketball stand)



g Long Screw*2



h Stopper*2
(for swing base)



i Screw*1



j Short Screw*2



k Net Hook*15
(for football net)



l Clip*4

ASSEMBLY INSTRUCTIONS

STEP1.

Install panel C on slide A with "+" shaped nuts a*6, and tighten them with wrench.

「A×1 C1+C2 a×6」

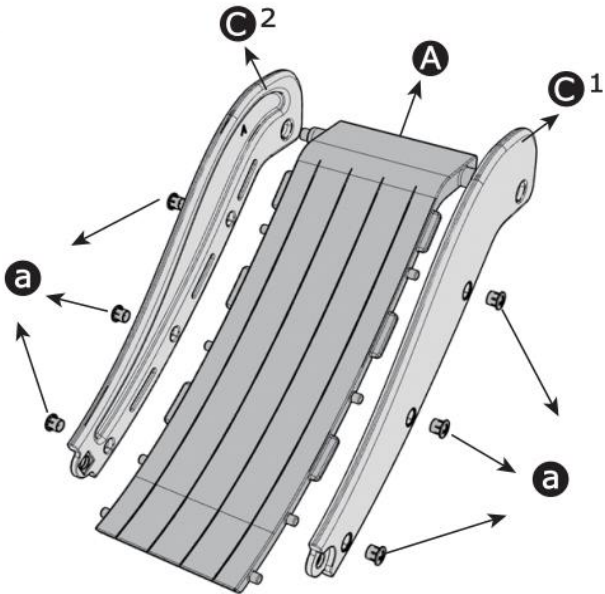

STEP2.

Put slide B and A together and align the holes, tighten long screws g*2 with the hex wrench.

「B×1 g×2」

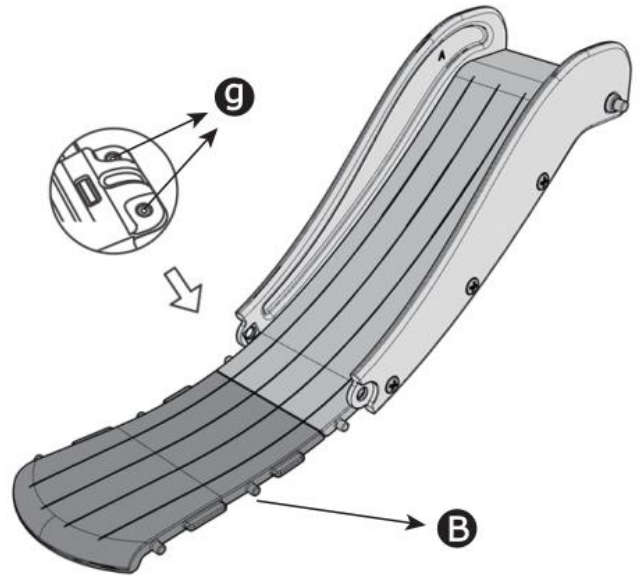

STEP3.

Install panel D on slide B with "+" shaped nuts a*6. Then, insert screws b*2 through the panel C and panel D, and tighten with nuts a*2 from outside.

「D1+D2 a×8 b×2」

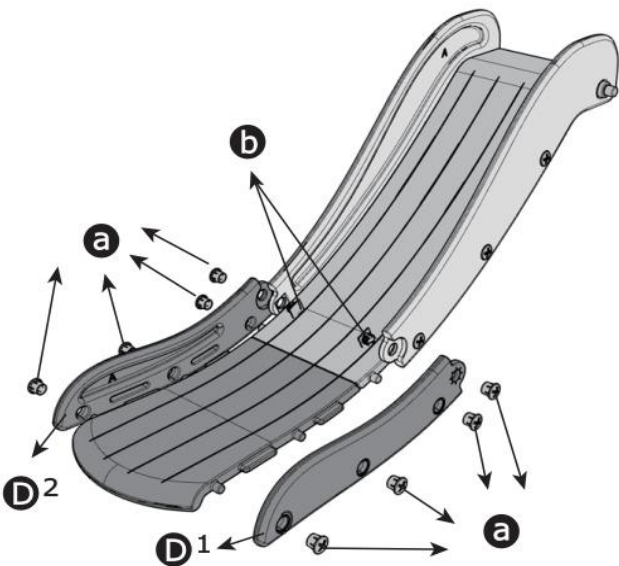

STEP4.

Attach steps F*4 to one board E with nuts c*4. Attach the slide to board E and tighten them with nut c*1

「E×1 F×4 c×5」

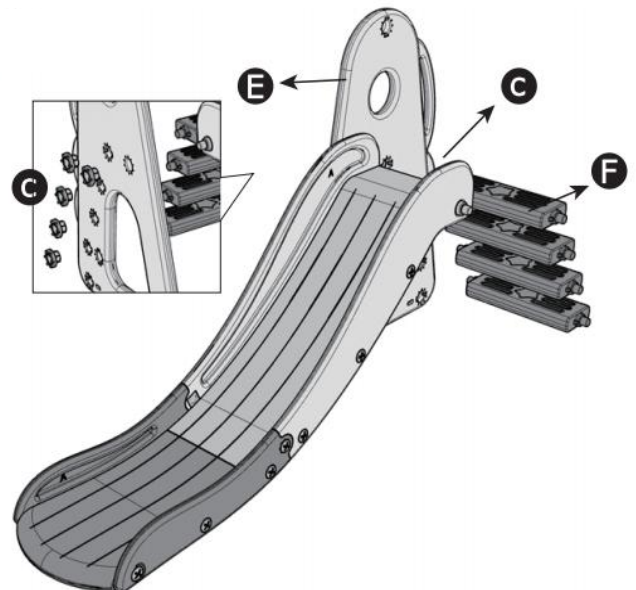

STEP5.

Attach steps and slide to another board E and tighten them with nuts c*5.

「E×1 c×5」

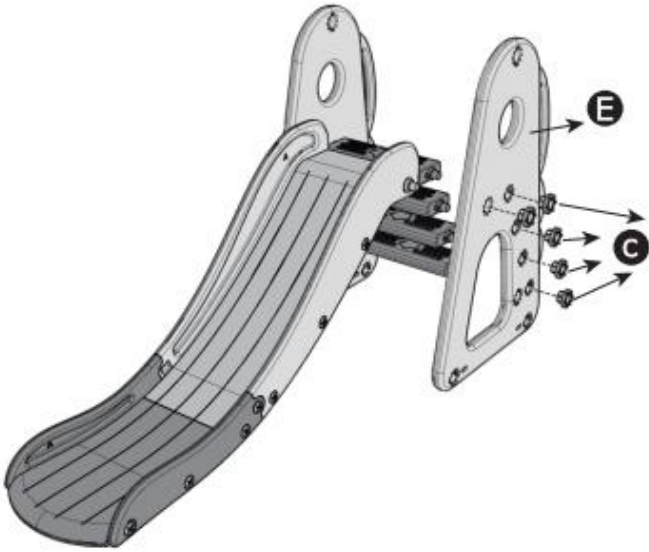

STEP6.

Tips: You can fill swing base with water or sand for better stability. Plug the holes with part h after that.

「I×2 h×2」

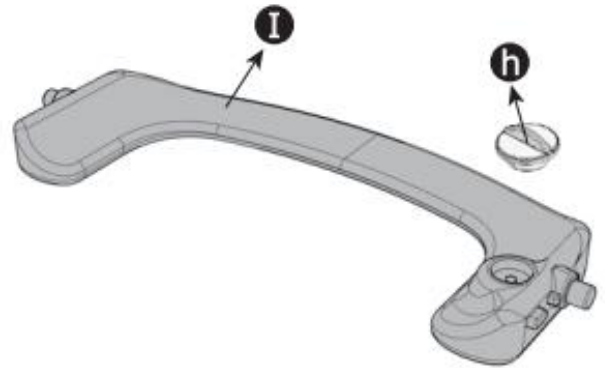

STEP7.

Attach armrest H to seat G with screw i.
Then attach board J to seat G with screws e*4.

「G×1 H×1 J×2 i×1 e×4」

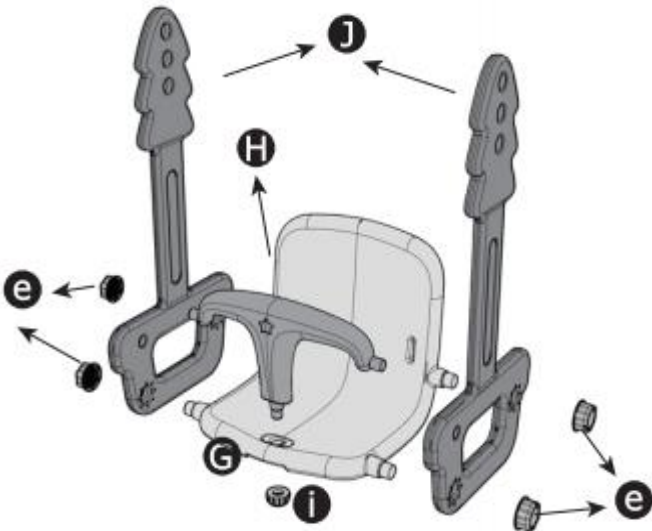

STEP8.

Attach swing base to board E with nuts c*2.
Insert stick K through board E and tighten with screw c.

「K×1 c×3」

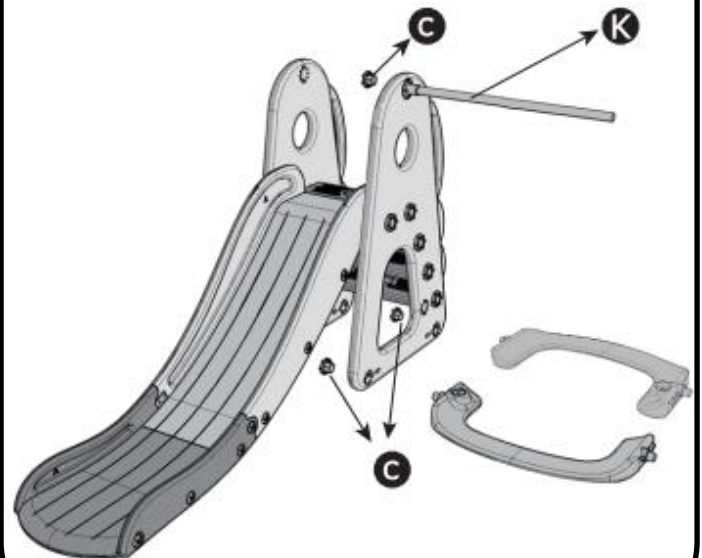

STEP9.

Remove the non-slip accessory on stick K, and choose a height you want and insert the stick through the holes on swing board.

Put the non-slip accessory back and attach swing base and the stick to another board E with nuts c*3.

Then, insert clips I*4 into the holes on stick to hold the swing.

「E×1 c×3 I×4」

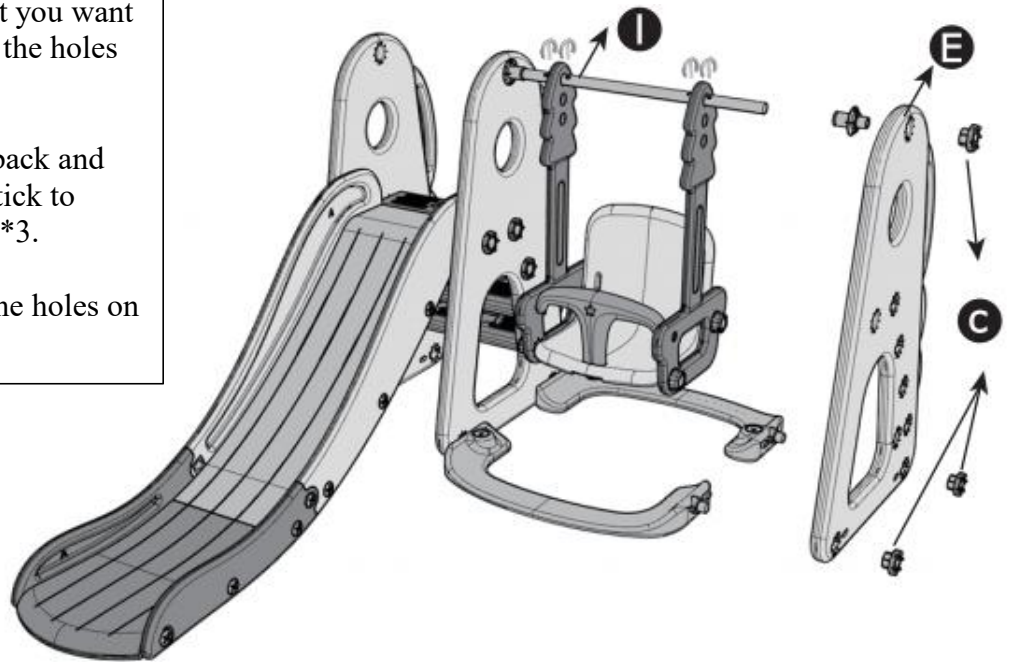

STEP10.

Attach back board N to panel M with “+” shaped nuts a*2.

Tips: You can fill the panel M with water or sand for better stability. Plug the holes with part f after that.

「M×2 N×1 a×2 f×2」

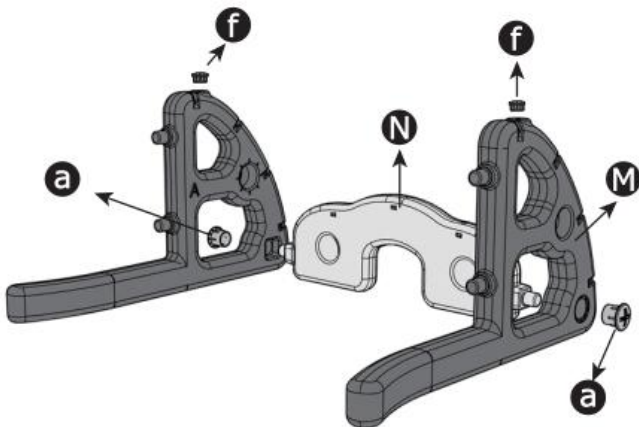

STEP11.

Attach pole S to football gate O, and tighten short screws j*2 with the hex wrench.

「S×1 O×1 j×2」

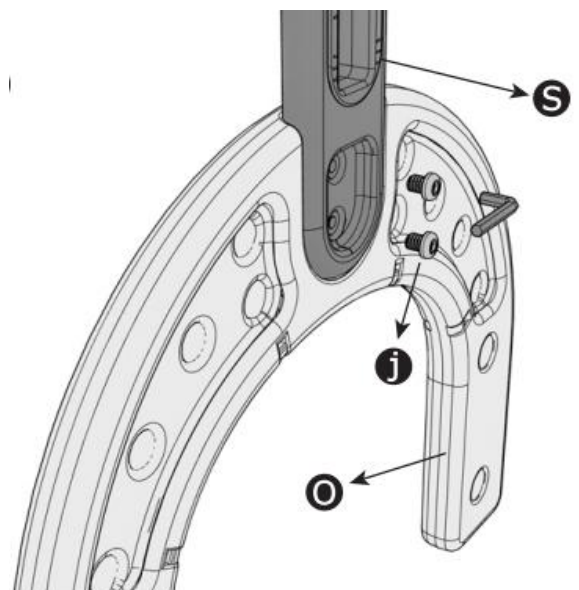

STEP12.

Attach gate O to panel M, and tighten nuts a*4 with wrench.

「a×4」

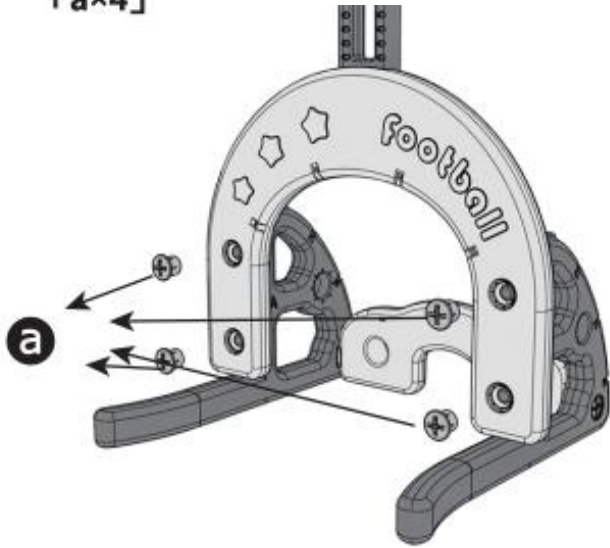

STEP13.

Attach net R to hoop Q and connect Q to board L, and insert into pole S, then tighten with screw e.

「L×1 Q×1 R×1 e×1」

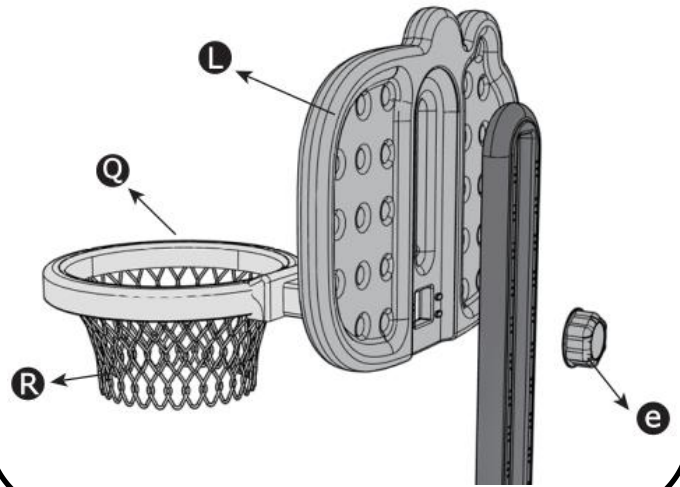

STEP14.

Attach net P to panel M with net hooks k*15.

「P×1 k×15」

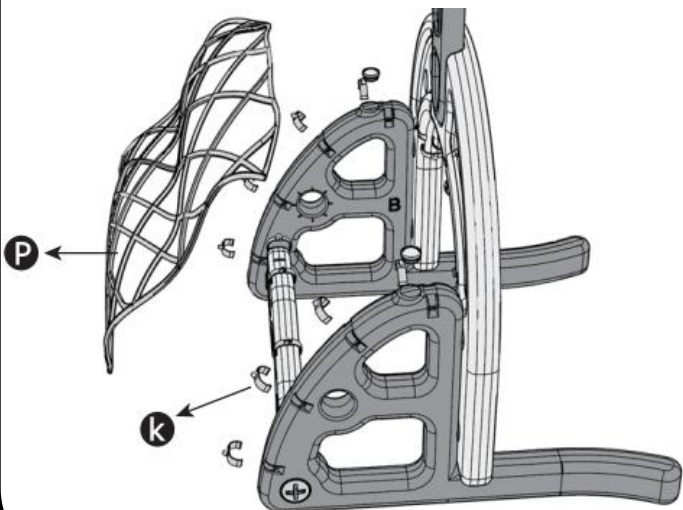

STEP15.

Attach panel M to swing board E with connector d and nuts c*2.

「d×1 c×2」

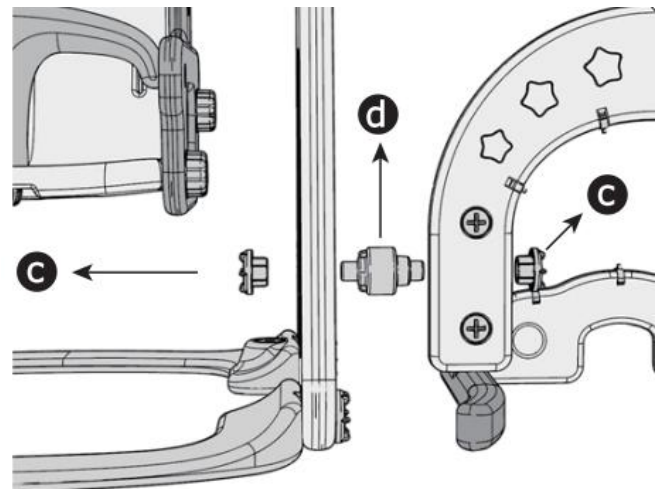

STEP16.

FINISHED

